

小型钮子开关

Miniature Toogle Switch

型号(TYPE):MTS-202-E1

技术特性 (Specification)

- 规格 (Rating):6A 125V AC; 3A 250V AC
- 接触电阻(Contact R):20mΩ max
- 绝缘电阻(Insulation R):500V DC 1000MΩ min
- 耐电压 (Dielectric Strength):1 Minute 1500V AC
- 操作温度(Operating Temperature):-25℃~+85℃
- 电气寿命(Electrical Life):10, 000 Cycles

外型图 (Outline Drawing)

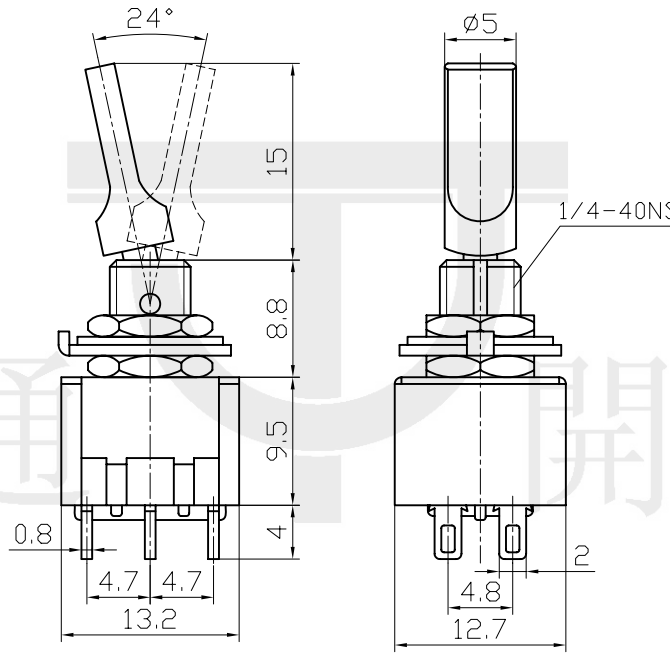

安装尺寸 (Mounting)

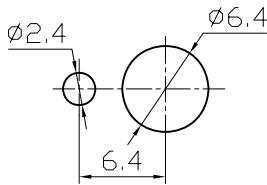

电路图 (Circuitry)

